

S Series

Description

The POPE Professional® S Series compact two-way loudspeaker provides a high quality sound reinforcement and resistance to weather. The S Series speakers are made for stand alone 100V operation.

Features

- 6", 8" and 10" Diameter, POPE Professional® Transducer
- Trapezoidal cabinet
- M6 points for safety harness
- Wall mountable design
- **SoundFlex®** coating
- 100V operation

Specifications

Model	: S-6T
Class	: 1*6" Two Way Speaker Speaker with LMT
Power Rating	: 50W Continuous*
Frequency Range	: 85Hz - 16kHz
Frequency Response	: 90Hz - 16kHz
Sensitivity (1W/1M)	: 92dB SPL

Transducer

Low Frequency	: 1*6" (127 mm) Diameter POPE Professional® Transducer
Power Rating	: 30 Watts Continuous 120 Watts Peak
Voice coil	: 19 mm (0.75")
Speaker Cone	: Paper Pulp dual cone
Magnet	: Ferrite
Impedance	: 8Ω

High Frequency	: 1*0.75" POPE Professional® Dome Tweeter
Input Power Rating	: 20 Watts Continuous 80 Watts Peak
Voice Coil Diameter	: 19 mm (0.75")
Magnet Material	: Ferrite
Diaphragm Material	: Polyester
Voice coil material	: Copper Clad Aluminium Wire
Sensitivity	: 101 dB SPL (1m @ 1w)
Nominal Impedance	: 8Ω
Frequency Response	: 1600 Hz - 16 kHz
Crossover Frequency	: 2.8 kHz
Crossover Mode	: Built in Passive Crossover Network

Enclosure

Cabinet Construction	: 12 mm, 7-ply birch Faced plywood Trapezoidal enclosure
Surface Finish	: SoundFlex® environment friendly coating
Mounting	: 4 x M6 points and keyhole hanging hook
Coverage Pattern (HxV)	: 100° x 100°
Input	: 100 Volt
Dimensions (H x W x D)	: 250 mm × 200 mm × 188 mm
Net Weight	: 3.5 kg

Packing (2 Speakers in 1 carton box)

Dimensions (H x W x D)	: 280 mm × 220 mm × 410 mm
Gross Weight	: 8.0 kg

Applications

The POPE Professional® S Series speakers can be used widely in meeting rooms, classrooms / schools, places of worship, courtrooms, multi zone paging / music, theme parks, museums, offices and etc.

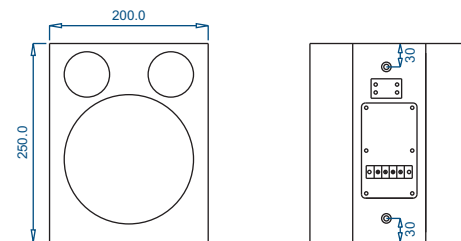

FRONT

REAR

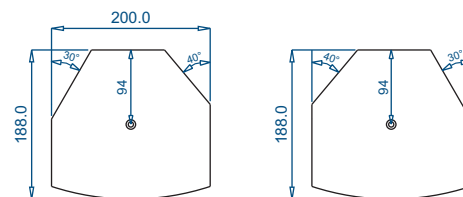

TOP

BOTTOM

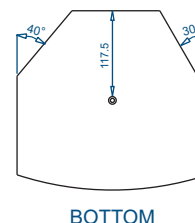
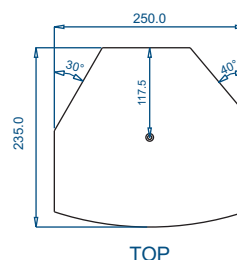
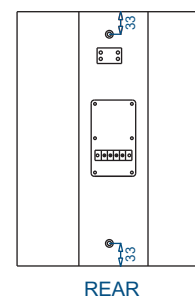
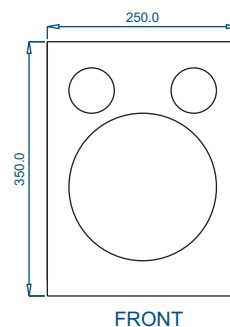
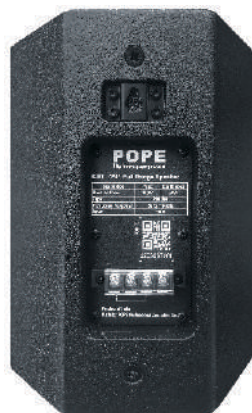

Specifications

Model

: **S-8T**

Class

: 1*8" Two Way Speaker with LMT

Power Rating

: 70W Continuous*

Frequency Range

: 85Hz - 16kHz

Frequency Response

: 90Hz - 16kHz

Sensitivity (1W/1M)

: 91dB SPL

Transducer

Low Frequency

: 1*8" (203 mm) Diameter POPE Professional® Transducer

Power Rating

: 50 Watts Continuous
200 Watts Peak

Voice coil

: 19 mm (0.75")

Speaker Cone

: Paper Pulp dual cone

Magnet

: Ferrite

Impedance

: 8Ω

High Frequency

: 1*0.75" POPE Professional® Dome Tweeter

Input Power Rating

: 20 Watts Continuous
80 Watts Peak

Voice Coil Diameter

: 19 mm (0.75")

Magnet Material

: Ferrite

Diaphragm Material

: Polyester

Voice coil material

: Copper Clad Aluminium Wire

Sensitivity

: 101 dB SPL (1m @ 1w)

Nominal Impedance

: 8Ω

Frequency Response

: 1600 Hz - 16 kHz

Crossover Frequency

: 2.8 kHz

Crossover Mode

: Built in Passive Crossover Network

Enclosure

Cabinet Construction

: 12 mm, 7-ply birch Faced plywood Trapezoidal enclosure

Surface Finish

: **SoundFlex®** environment friendly coating

Mounting

: 4 x M6 points and keyhole hanging hook

Coverage Pattern (HxV)

: 100° x 100°

Input

: 100 Volt

Dimensions (H x W x D)

: 350 mm × 250 mm × 235 mm

Net Weight

: 5.1 kg

Packing (2 Speakers in 1 carton box)

Dimensions (H x W x D)

: 380 mm × 280 mm × 515 mm

Gross Weight

: 11.8 kg

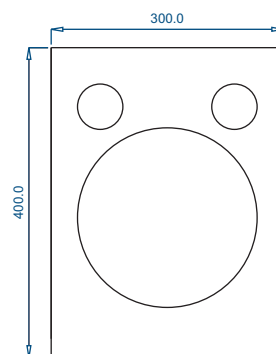
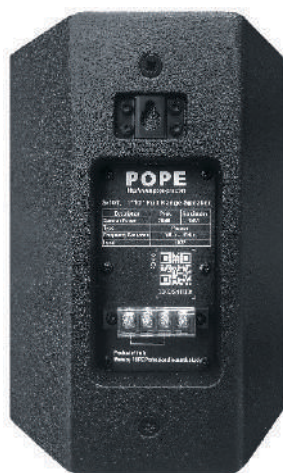

FRONT

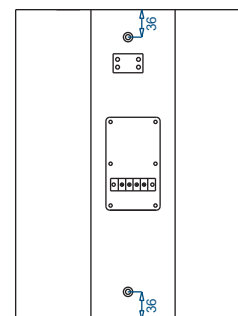

REAR

Specifications

Model

: S-10T

Class

: 1*10" Two Way Speaker with LMT

Power Rating

: 120W Continuous*

Frequency Range

: 75Hz - 16kHz

Frequency Respons

: 80Hz - 16kHz

Sensitivity (1W/1M)

: 93dB SPL

Transducer

Low Frequency

: 1*10" (254 mm) Diameter POPE Professional® Transducer

Power Rating

: 100 Watts Continuous
400 Watts Peak

Voice coil

: 25 mm (1")

Speaker Cone

: Paper Pulp dual cone

Magnet

: Ferrite

Impedance

: 8Ω

High Frequency

: 1*0.75" POPE Professional® Dome Tweeter

Input Power Rating

: 20 Watts Continuous
80 Watts Peak

Voice Coil Diameter

: 19 mm (0.75")

Magnet Material

: Ferrite

Diaphragm Material

: Polyester

Voice coil material

: Copper Clad Aluminium Wire

Sensitivity

: 101 dB SPL (1m @ 1w)

Nominal Impedance

: 8Ω

Frequency Response

: 1600 Hz - 16 kHz

Crossover Frequency

: 2.8 kHz

Crossover Mode

: Built in Passive Crossover Network

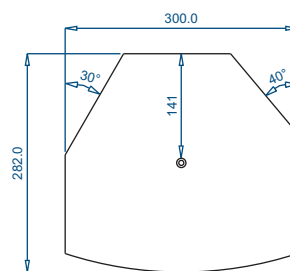

TOP

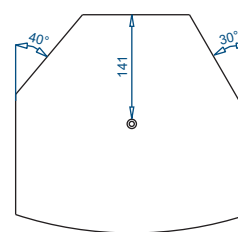

BOTTOM

Enclosure

Cabinet Construction

: 12 mm, 7-ply birch Faced plywood Trapezoidal enclosure

Surface Finish

: **SoundFlex®** environment friendly coating

Mounting

: 4 x M6 points and keyhole hanging hook

Coverage Pattern (HxV)

: 100° x 100°

Input

: 100 Volt

Dimensions (H x W x D)

: 400 mm × 300 mm × 282 mm

Net Weight

: 7.4 kg (16.31 lbs)

Packing (2 Speakers in 1 carton box)

Dimensions (H x W x D)

: 430 mm × 330 mm × 610 mm

Gross Weight

: 17.2 kg